

Series load cells: **CLS**

Up to 2000 kg application range



MAX STATIC LOAD	kg	FOR LOAD CELLS	NET WEIGHT (kg)	CODE
	2000	CLS (1000 - 2000 kg)	0.6	PVCLS

Load cell not included

DESCRIPTION

- Adjustable upper plate in AISI 304 stainless steel (PPV).
- Constraint against lateral forces and anti-tilt by stainless steel self-centering joint foot.
- Compensation for any misalignments of the support plates of the structure.
- Adjustable height.

MOUNTING KIT for COMPRESSION - LOW PROFILE load cells

DIMENSIONS AND TECHNICAL SPECIFICATIONS

- Finished the installation by means of a copper wire, connect the upper supporting plate with the lower supporting plate, then connect all the lower plates to the earthing system.
- In case of structure with four-point support, if one-point does not touch the support base of the foot, you must proceed to adjust foot height.

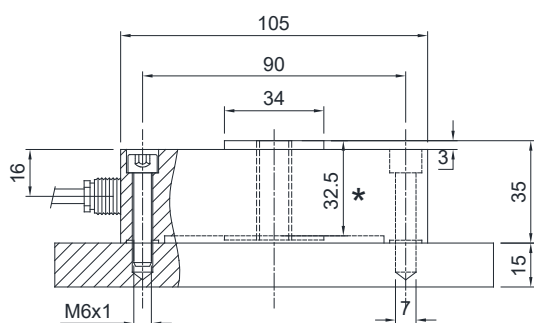
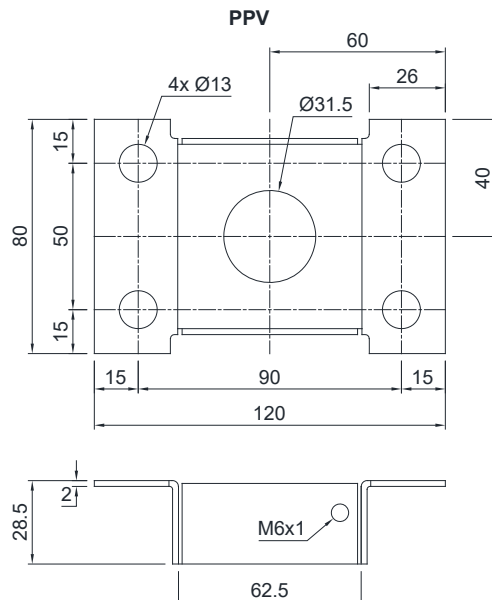
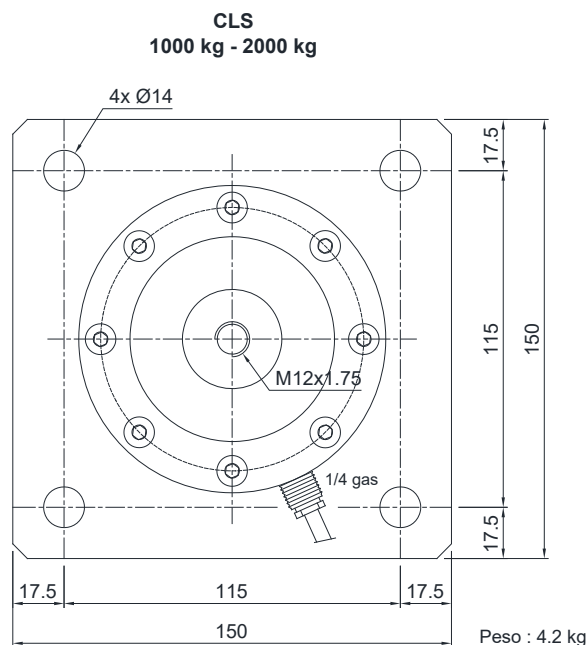
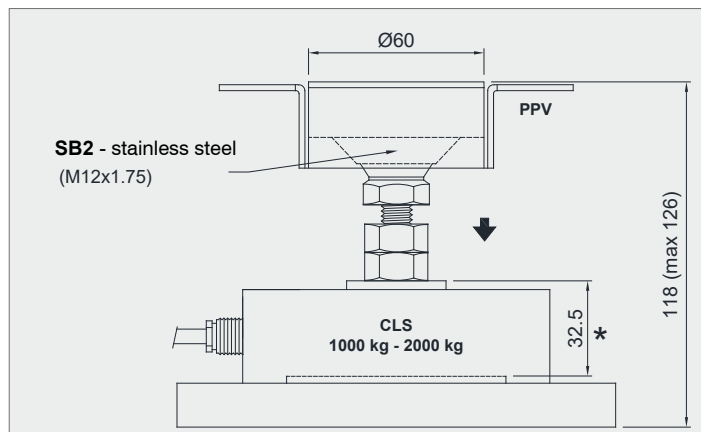

*** WARNING!**
Max dimension to insert the bolt to allow the cell to perform properly

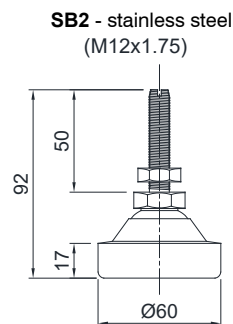

FIXING TO THE WEIGHED STRUCTURE

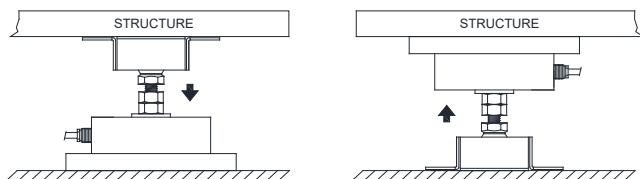

POSSIBLE UPPER PLATE POSITIONS

