



Manufactured according to OIML R60 standards

Capacity from 1000 kg to 5000 kg



- AISI 420 STAINLESS STEEL
- COMBINED ERROR  $\leq \pm 0.03\%$
- IP68 PROTECTION RATING
- INTEGRATED STAINLESS STEEL LOWER PLATE

### MOUNTING KITS



CAPACITY	kg	NET WEIGHT (kg)
1000		4.1
2000		4.1
5000		4.1

### CERTIFICATIONS



Complies with the Eurasian Customs Union standards



Equivalent of the CE marking for the United Kingdom

#### CERTIFICATIONS ON REQUEST



Linearity test



ATEX II 1GD (zone 0-1-2-20-21-22) (CE - UKCA)



IECEx (zone 0-1-2-20-21-22)



Complies with the Eurasian Customs Union standards for use in potentially explosive atmospheres

### DIMENSIONS (mm)

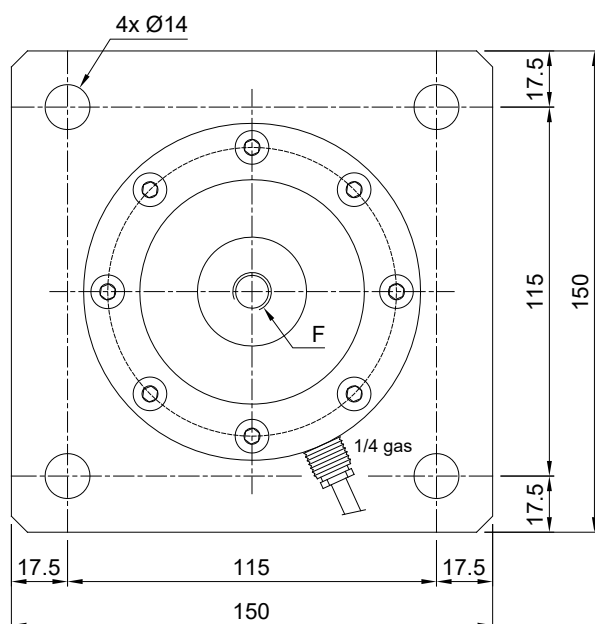

	F
kg 1000	M12 x 1.75
kg 2000	M12 x 1.75
kg 5000	M20 x 2.5

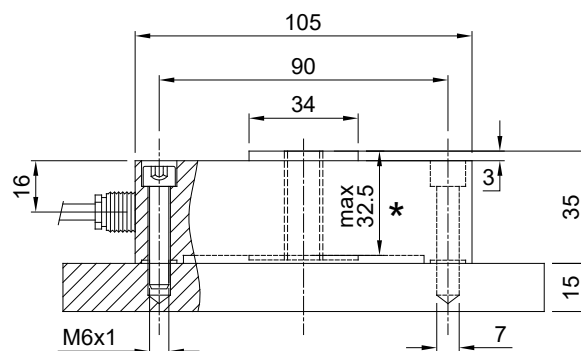
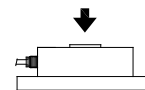

\* WARNING! Max dimension to insert the bolt to allow the cell to perform properly

### TECHNICAL FEATURES

Material	AISI 420 stainless steel		
Nominal load (E max)	1000 - 2000 - 5000 kg		
Combined error	$\leq \pm 0.03\%$		
Protection rating	IP68		
Rated output	2 mV/V $\pm 0.4\%$	Input resistance	385 $\Omega \pm 10$
Temperature effect on zero	0.002% $^{\circ}\text{C}$	Output resistance	350 $\Omega \pm 3$
Temperature effect on span	0.012% $^{\circ}\text{C}$	Zero balance	$\pm 1\%$
Compensated temperature range	-10 $^{\circ}\text{C}$ / +50 $^{\circ}\text{C}$	Insulation resistance	>5000 M $\Omega$
Operating temperature range	-20 $^{\circ}\text{C}$ / +70 $^{\circ}\text{C}$	Safe overload (% of full scale)	150%
Creep at nominal load in 30 minutes	0.02%	Ultimate overload (% of full scale)	250%
Max supply voltage without damage	15 V	Deflection at nominal load	0.3 mm

### ELECTRICAL CONNECTIONS

Cable length	10 m
Cable diameter	6 mm
Cores	6 x 0.25 mm <sup>2</sup>

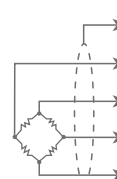

SHIELD	
+ SIGNAL	GREEN
+ EXCITATION + REF./SENSE	RED BLUE
- SIGNAL	WHITE
- EXCITATION - REF./SENSE	BLACK YELLOW