

Series load cells: FTK - FT-P - FTKL - FTZ - FTP - CLS

Up to 10000 kg application range



MAX STATIC LOAD kg	DESCRIPTION	FOR LOAD CELLS	NET WEIGHT (kg)	CODE
2000	Axial spherical plain bearing	CLS, FTK, FTKL, FTP, FT-P, FTZ	0.07	SNODOGE12
5000	Kit composed by bearing, galvanized bolt (20x80 mm) and washer (22x60 mm).	CLS (5000 kg), FTK (3000-5000 kg), FTKL, FTZ (5000 kg), FTP (3000-5000 kg)	0.3	SNODOGE20
10000	Kit composed by bearing, galvanized bolt (24x100 mm) and washer (26x72 mm).	FTP 10000 kg	0.9	SNODOGE25

### DIMENSIONS AND APPLICATION

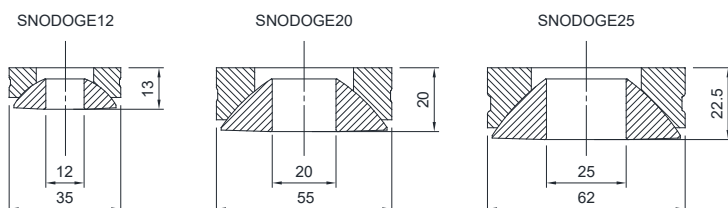

### DESCRIPTION

- Hardened 100Cr6 steel bearing to compensate for misalignment of the support plates.

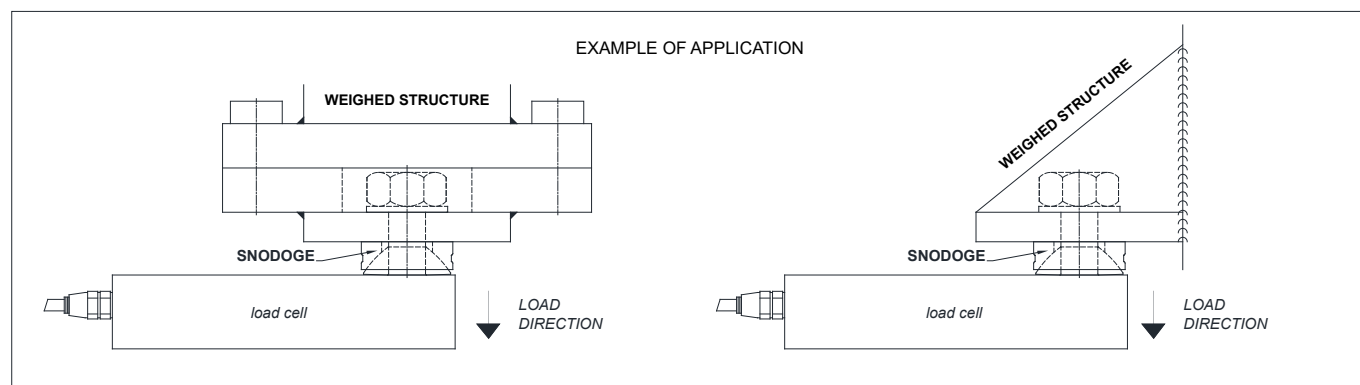

The Company reserves the right to make changes to the technical data, drawings and images without notice.