

PV80CLS

MOUNTING KIT for COMPRESSION-LOW PROFILE load cells

LAUMAS®

Series load cells: CLS

Up to 5000 kg application range



MAX STATIC LOAD	kg	FOR LOAD CELLS	NET WEIGHT (kg)	CODE
	5000	CLS (5000 kg)	1.5	PV80CLS

Load cell not included.

DESCRIPTION

- Adjustable upper plate in AISI 304 stainless steel (PPV80).
- Constraint against lateral forces and anti-tilt by stainless steel self-centering joint foot.
- Compensation for any misalignments of the support plates of the structure.
- Adjustable height.

DIMENSIONS AND TECHNICAL SPECIFICATIONS

- Finished the installation by means of a copper wire, connect the upper supporting plate with the lower supporting plate, then connect all the lower plates to the earthing system.
- In case of structure with four-point support, if one-point does not touch the support base of the foot, you must proceed to adjust foot height.

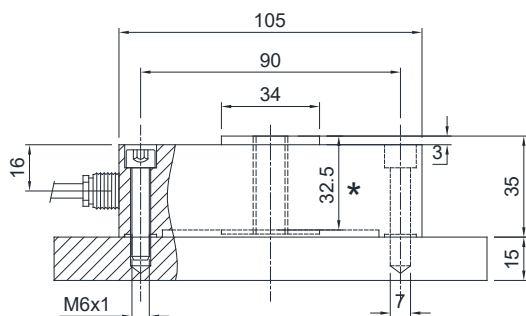
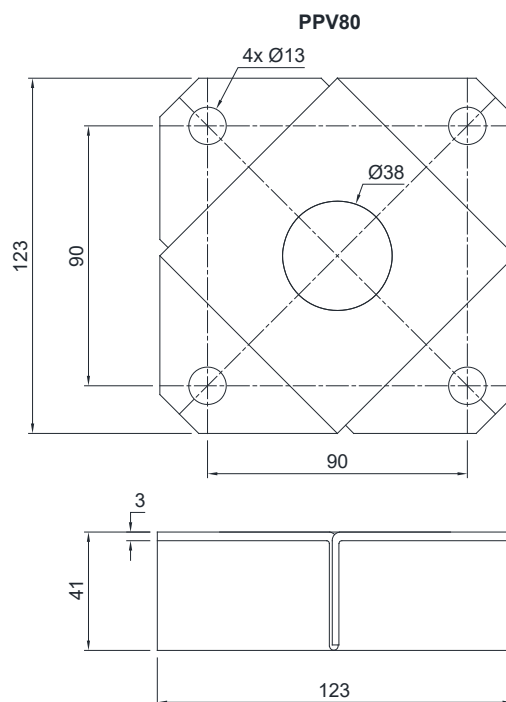
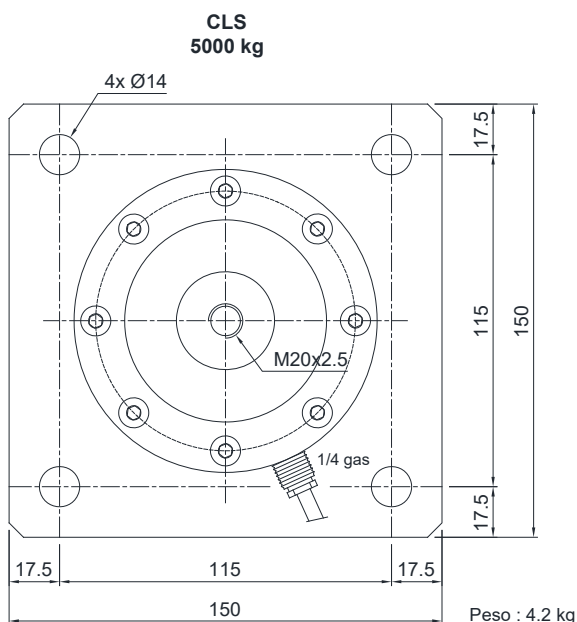
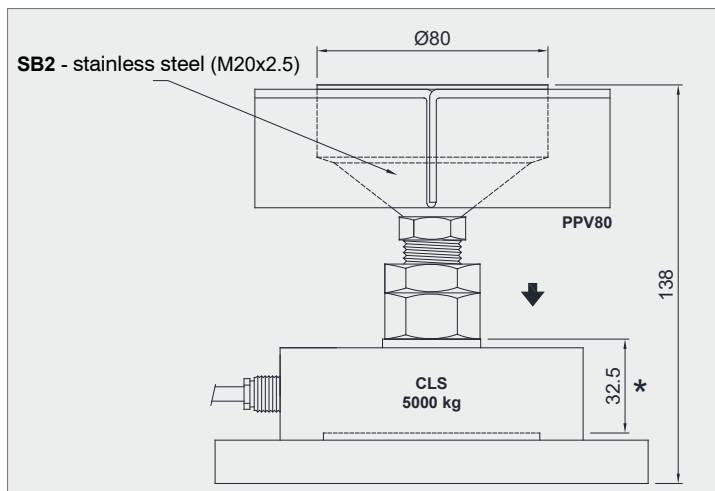

* **WARNING!**
Max dimension to insert the bolt to allow the cell to perform properly

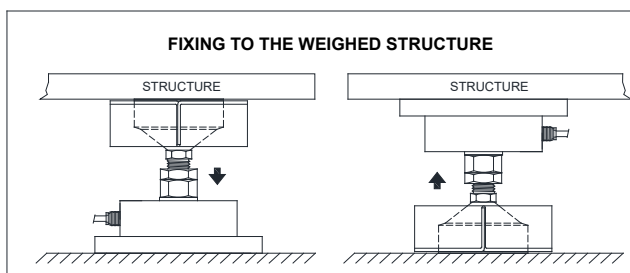

POSSIBLE UPPER PLATE POSITIONS

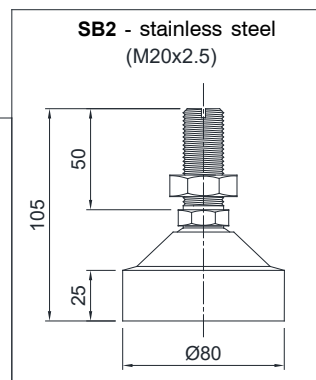
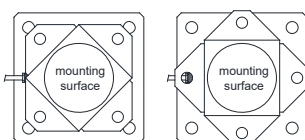

The Company reserves the right to make changes to the technical data, drawings and images without notice.